



AXD SMOKE AND HEAT EXHAUST FANS

Smoke and heat exhaust fans are certified according to EN 12103-3: 2015 in the categories F200, F300 and F400. Smoke and heat exhaust fans are mainly used for the removal of smoke in the event of fire breaking out, which minimizes the suffocation hazard and creates a smoke-free escape route. They can be used in an axial, centrifugal, roof and box model.

Sizes	400 up to 1.600 mm
Motor	HT motor IP55, 400/3/50
Capacity	up to 200.000 m ³ /hr.
Pressure	up to 1.600 Pa
Control	Frequency converter
Casing	Galvanized Sheet Metal
Impeller	Aluminum
Airflow	Motor × Impeller / Impeller × Motor
Extra	Motors for different voltages, frequencies and with certificates



Application

The fan are used for the removal of smoke in the event of fire breaking out, which minimizes the suffocation hazard and creates a smoke-free escape route. The fan is intended for all types of general ventilation installations.

Typical applications are:

general ventilation systems of commercial and industrial premises, ventilation of storage facilities, ventilation of garages, public utility buildings, etc.

Construction

Impeller is made of aluminum alloy, Casing is made of Galvanized Sheet Metal,

Body Coating: None

Flow direction impeller -> motor, motor -> impeller

Installation in a horizontal or vertical position.

MOTOR

- Motor Insulation Class H
- Motor Protection Class IP 55

- Motor Efficiency Class IE3
- Motor Enclosure Type TEAO
- Motor Brand WEG
- Available with three phase motors in 2, 4 poles.
- Available with One and two speed motors,
- F400-120 motors are IP55, class H insulation.
- F300-120 motors are IP55, class H insulation.

On request

Painting in a color other than the standard, painting in a higher corrosivity category, motor for other than standard voltage and power frequency, motor with a different degree of protection, motor with a different insulation class, motor equipped with sensors or additional cooling.

Accessories

Inlet cone / Silencers / Protection grid / Shutters / Inspection window/ Flexible connections / Anti-vibration mounts / Support feet / Flanges / Switches/ Terminal box / Frequency converters.





4 poles (1.500 rpm.) – 400/3/50

Model	Capacity max (m3/h)	Motor (kW)	In max (A)	Frequency (HZ)
400/4D/0.37	3.900	0.37	0,60	50
450/4D/0.55	4.100	0.55	1,20	50
500/4D/0.55	5.845	0,55	1,60	50
560/4D/0.75	8.150	0,75	2,00	50
630/4D/1.10	13.480	1,1	2,80	50
710/4D/1,50	19.210	1,5	3,50	50
800/4D/2.20	25.560	2.2	6,50	50
800/4D/3.00	30.940	3.0	8,20	50
900/4D/4.00	39.250	4.0	11,0	50
900/4D/5.50	44.635	5.5	15,0	50
900/4D/11.0	46.200	11.0	18,0	50
1000/4D/7.5	54.570	7,5	15,0	50
1000/4D/15	62.250	15	27,8	50
1000/4D/18.5	69.070	18,5	32,6	50
1125/4D/22	86.620	22	38,8	50
1125/4D/30	95.270	30	53,0	50

Indication dimensions AXF-Duct

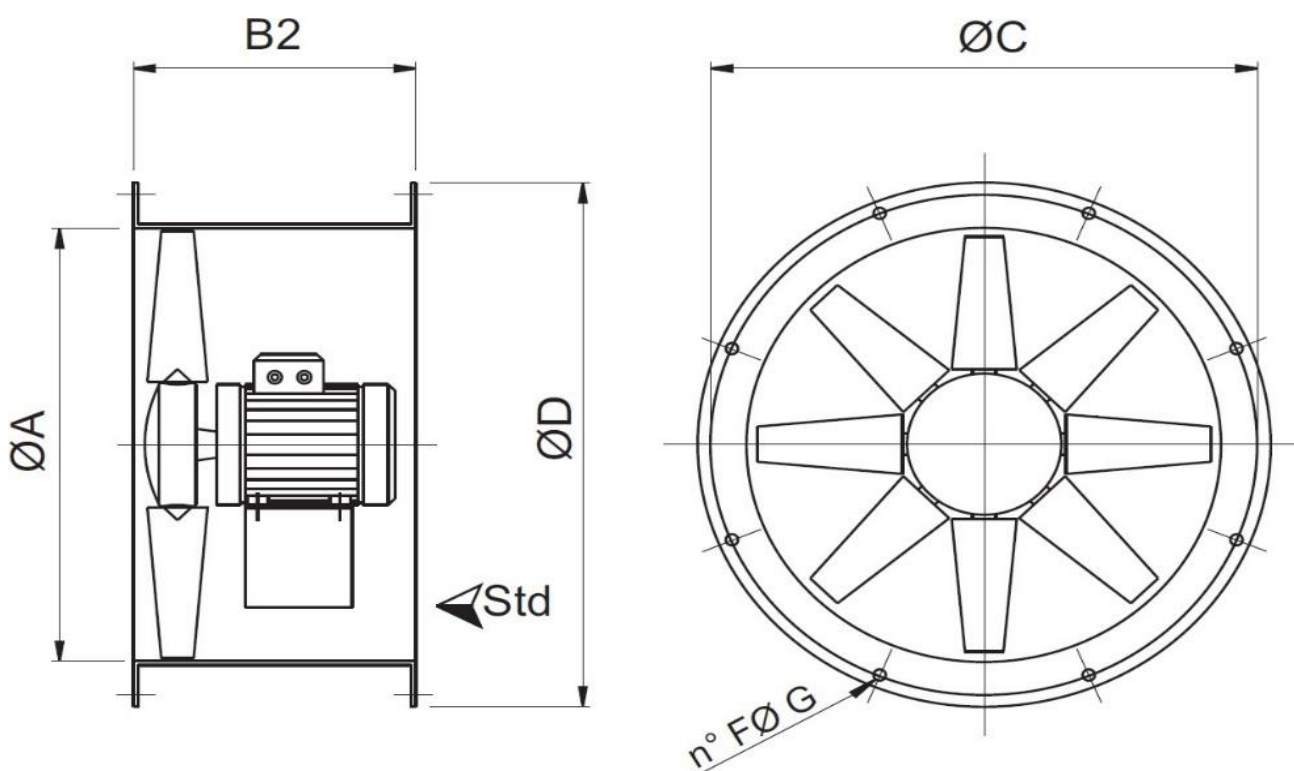



Model	Ø A	B2	Ø C	Ø D	F	G
400	410	400	450	490	8	12
450	460	450	500	540	8	12
500	510	450	560	600	12	12
560	570	450	620	655	12	12
630	640	500	690	725	12	12
710	710	600	770	805	16	12
800	810	600	860	905	16	12
900	910	700	970	1010	16	16
100	1010	800	1070	1115	16	16
1120	1130	800	1190	1235	20	16
1250	1260	800	1320	1365	20	16

